

1 2 3 4 5 6 7 8

| ECN | | | | | |
|-----|------|--------------------|----------------|------|------------|
| REV | MARK | Reasons for change | Change content | Name | Date |
| A | | First Release | First Release | TFR | 2024.08.21 |

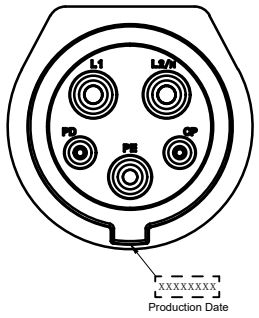
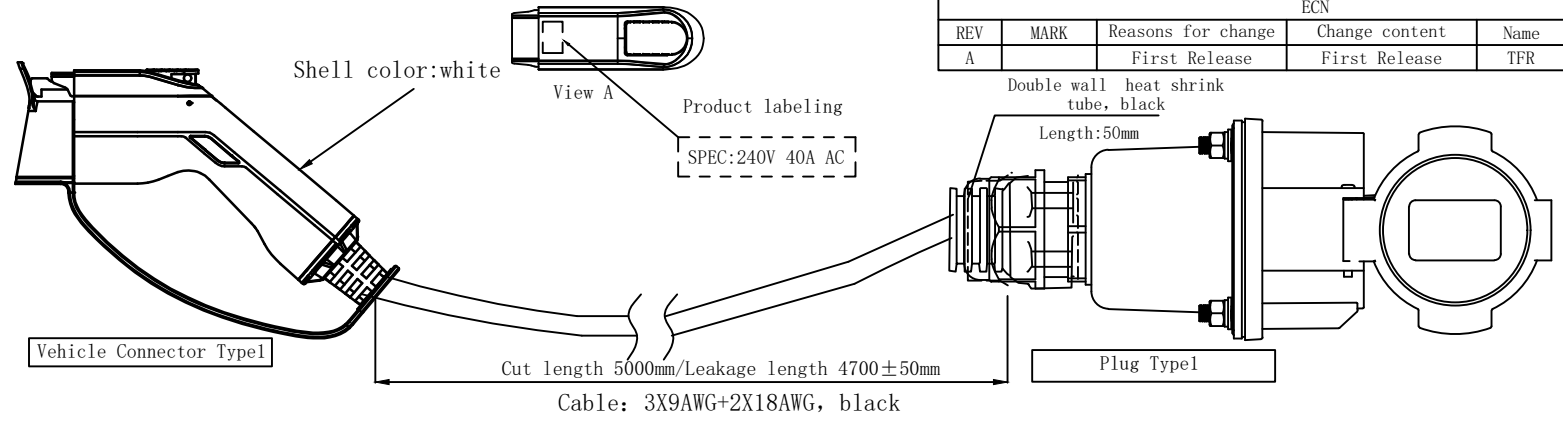

Vehicle Connector wiring diagram

Plug wiring diagram

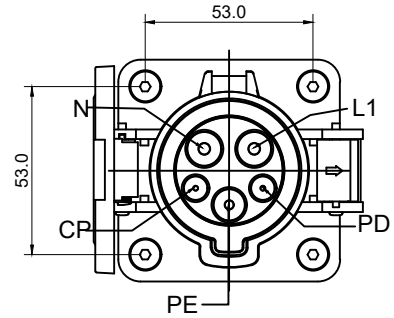
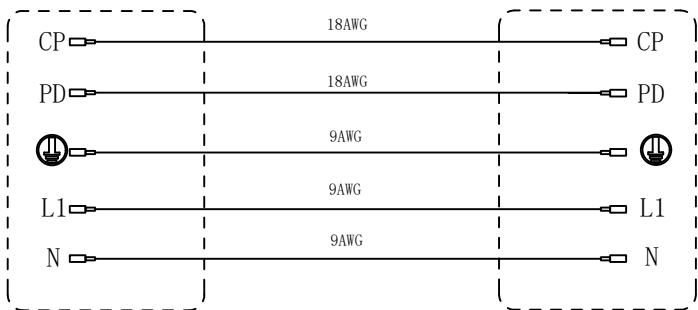

Technical Requirement:

1. Product description: Vehicle Connector meets the design and test requirements of SAE J1772-2010; Plug meets the design and test requirements of IEC 62196-2014
2. Product performance: Voltage rating 240V
Current rating 40A
Dielectric Withstanding Voltage >2500V
3. Appearance of the product: No oil stain, burr or other defects affecting the function of the product are found on the surface of the product.
4. Control dimension: The dimension marked is the key dimension, which needs to be controlled.
5. Environmental protection requirements: products meet RoHS requirements;

Customer signature:



| | | | | | | | | |
|----------|-------|--------|-------|---------------------|-----------|---------------------------------|-----------------|----------------|
| Approval | Check | Design | | -Unnoted tolerance- | | SPvolt EV Charging Cable Co.Ltd | | |
| | | | | Unit: mm | X | ±0.30 | info@spvolt.com | |
| | | | | Sheet: A4 | X.X | ±0.20 | Name: | TYPE1 TO TYPE1 |
| | | | | Scale: | X.XX | ±0.10 | Part number: | |
| Page: | | | Angle | ±1° | Material: | Weight: | Draw number: | YT2-YCX-02-3 |

1 2 3 4 5 6 7 8